

KTL FLEXIPRO 21 + LINOLEUM

FLEXIPRO 21 + LINO

KTL FLEXIPRO 21 + Linoleum is a high performance area elastic sports floor, installed floating on levelled concrete or wooden subfloor. Total height is 30 mm incl. PU.

The resilience of the floor system is secured through the elastic FlexiPro base floor, where continuous rubber strips in two thicknesses, placed in grooves on the back, feature progressive shock absorbency, executed by even low impact from e.g. children.

The sports functional characteristics feature high shock absorbency and resilience combined with a great stability under foot, designed for multipurpose use with focus on ball games, badminton and gymnastics. Tested and conforms fully to EN 14904, Class A4.

A build-in deformation control secures ultimate loading capacity to the floor.

The floor design makes it ideal over underfloor heating.

COMPOSITION OF FLOOR SYSTEM

1. Sports linoleum:

Sports linoleum in 4mm, alternatively 3.2mm, full surface adhesion to base floor with welded joints.

Tarkett:

Linosport XF, Linosport Classic.

DLW-Armstrong:

Linodur Sport, Linovation Sport,

Linopro Sport, Linea Sport

Forbo: Marmoleum Sport

2. KTL FlexiPro 21 base floor:

Area elastic base sports floor of 21x575x2200mm birch ply sheets, supported by continuous elastic EvaZote rubber strips in 10mm / 8mm thickness, recessed / glued into grooves on the panel underside. Special tongue/groove profiles along all 4 sides of panels secure fast and safe connection by gluing into one floating area.

Sub floor height is: 26mm.

The base floor complies with EN 14904.

3. Moisture barrier:

0.20 mm PE-folio (on concrete) laid with 200mm overlaps and taped joints.

4. Subfloor:

Concrete, alternatively existing floor, levelled to a maximum deviation of ± 2 mm on a 2 meter straight-edge.

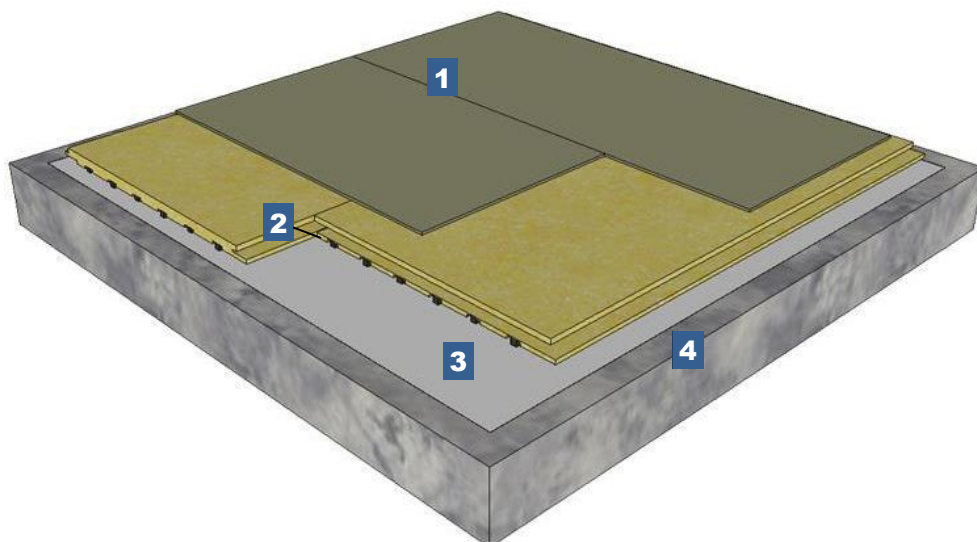

Test methods	EN standards	EN demands acc. to Class A4	Results*
Shock absorption [%]	EN 14904:2006	55 – 75	59
Standard deviation [mm]		2.3 – 5.0	2.9
Ball rebound [%]	EN 12335:2004	≥ 90	97
Rolling load [N]	EN 1569	Min. 1500	>1500
Friction	EN 13036-4	80 – 110	80 – 110

*) Tested by Danish Technological Institute, Denmark.

Line marking:	Applied directly on the linoleum.
Finish layer:	Polish treatment which is also used for maintenance. OBS! If resin is used for handball, the surface must be PUR coated.
Renovation:	The linoleum can be maintained by buffing and recoating of PUR.
Underfloor heating:	Waterborne or electrical based underfloor heating system is ideal in combination with the KTL FlexiPRO systems. Heating system must have its own heating circuit and separate temperature regulation. Surface temperature of finished floor must not exceed 27°C.

MANUFACTURER

KTL INTERNATIONAL SDN BHD
Lot 121 & 123, Jalan Enam,
Komplek Perabot Olak Lempit,
4270 Banting, Selangor, Malaysia

SALES & SUPPORT

KTL Domestic +60 3 3149 3128
KTL Export +60 1 22676366
KTL Europe +45 4432 8450
www.ktlfloor.com • sales@ktlfloor.com

KTL SPORTS FLOORING
SPECIFICATION
FLEXIPRO 21 + LINOLEUM SYSTEM
G 4.2
29-05-2019 (UK)

